



# NORTH CAROLINA DEPARTMENT OF TRANSPORTATION

## PROPOSED ROADSIDE ENVIRONMENTAL SUSTAINABLE DESIGN & AESTHETICS PROJECT

T.I.P. #	W.B.S. #	SHEET #	SHEET # TOTAL
R-2519A(L)	35609.3.3	L1A	9
PROJ. #	DESCRIPTION	DIVISION	
DM00430	Aesthetic Landmark Development	13	



### CONVENTIONAL SYMBOLS

County Line	-----
City or Town Line	-----
Exist. Right of Way Line Marker	-----▲-----
Prop. Right of Way Line Marker (By Others)	-----▲-----
Prop Right of Way Line Marker (By Contract)	-----▲-----
Exist. Control of Access Line	-----⊕-----
Prop. Control of Access Line	-----⊕-----
Property Line	-----E-----
Easement Line	-----E-----
Slope Stake Line	-----S-----
Exist. Fence	-----+-----
Prop. Woven Wire Fence	-----+-----
Prop. Chain Link Fence	-----+-----
Exist. Road	=====
Prop. Road	=====
Guardrail	-----+-----
Survey Line	-----+-----
Denotes Line Equality	-----+-----
Bridge	-----+-----
Culvert	-----+-----
Railroad	-----+-----
Woods	-----+-----
Exist. Telephone Pole	-----+-----
Prop. Telephone Pole	-----+-----
Tower Pole and Line	-----+-----
Exist. Power Pole	-----+-----
Prop. Power Pole	-----+-----
Sanitary Sewer Line	-----+-----
Water Line	-----+-----
Gas Line	-----+-----
Picnic Shelter	-----+-----
Regeneration	-----+-----
Reforestation	-----+-----
Large Deciduous Tree	-----+-----
Evergreen Tree	-----+-----
Small or Flowering Tree	-----+-----
Shrubs	-----+-----
Planting Bed	-----+-----

### Summary of Quantities

QUANTITY	UNIT	KEY	BOTANICAL NAME	COMMON NAME	FURNISH	
Small Flowering Trees (LARGE)						
9	EA	AGL	Amelanchier x grandiflora 'Autumn Brilliance'	Autumn Brilliance Serviceberry	2-2 1/2" CAL., 8-10', B&B, 1.2.3 Specimen-Matching	As Shown
56	EA	CCL	Cercis canadensis 'Forest Pansy'	Forest Pansy Redbud	2-2 1/2" CAL., 8-10', B&B, 1.2.3 Specimen-Matching	As Shown
9	EA	CKL	Crataegus viridis 'Winter King'	Winter King Hawthorne	2-2 1/2" CAL., 8-10', B&B, 1.2.3 Specimen-Matching	As Shown
Evergreen Trees (LARGE)						
13	EA	PAL	Picea abies	Norway Spruce	8-10', B&B, Specimen 3.1.2.4	As Shown
Deciduous Trees (LARGE)						
1	EA	ABL	Acer rubrum 'Autumn Blaze'	Autumn Blaze Red Maple	2 1/2"-3" Cal., 14-16', B&B, Specimen	As Shown
2	EA	ASL	Acer saccharum 'Green Mountain'	Green Mountain Sugar Maple	2 1/2"-3" Cal., 14-16', B&B, Specimen	As Shown
2	EA	QSL	Quercus shumardii	Shumard Oak	2 1/2"-3" Cal., 14-16', B&B, Specimen	As Shown
2	EA	TDL	Taxodium distichum	Bald Cypress	2 1/2"-3" Cal., 10-12', B&B, Specimen	As Shown
Shrubs / Native Grass and Perennial Varieties						
100	EA	EC	Echinacea purpurea 'Firebird'	Purple Coneflower	#1 Cont.	24" O.C.
405	EA	HB	Hemerocallis 'Buttered Popcorn'	Buttered Popcorn Daylily	#1 Cont.	24" O.C.
58	EA	IV	Illex verticillata 'Red Sprite'	Red Sprite Winterberry	#3 Cont.	5' O.C.
1860	EA	IC	Iris 'Ceasar's Brother'	Ceasars' Brother Bearded Iris	Single Fan Rhizome	2' O.C.
2265	EA	ND	Narcissus 'Dutch Master'	Dutch Master Daffodil	DNII	2' O.C.
46	EA	PV	Panicum virgatum 'Cloud Nine'	Cloud Nine Panicum	#1 Cont.	2' O.C.
82	EA	RB	Rhododendron 'Autumn Bonfire'	Encore Azalea Autumn Bonfire	#3 Cont.	As Shown
55	EA	RL	Rhododendron 'Autumn Lilac'	Encore Azalea Autumn Lilac	#3 Cont.	As Shown
17	EA	RC	Rhododendron catawbiense 'Roseum Elegans'	Roseum Elegans Rhododendron	#3 Cont.	As Shown
460	EA	RF	Rudbeckia fulgida 'Goldstrum'	Black Eyed Susan	#1 Cont.	2' O.C.
Descriptions						
312	SF	SP	WORK ZONE ADVANCE/GENERAL WARNING SIGNING			
8	LF	SP	PEDESTRIAN CHANNELIZING DEVICES			
1	LS	SP	TEMPORARY TRAFFIC CONTROL			
0.3	ACR	1651	SELECTIVE UNDERGROWTH REMOVAL			
1.3	ACR	SP	SEEDING AND MULCHING			
50	LB	1661	SEED FOR REPAIR SEEDING			
0.05	TON	1661	FERTILIZER FOR REPAIR SEEDING			
50	LB	1662	SEED FOR SUPPLEMENTAL SEEDING			
200	M/G	1664	WATER			
0.25	TON	1665	FERTILIZER TOPDRESSING			
1	EA	SP	CONCRETE WASHOUT STRUCTURE			
1.3	ACR	SP	SPECIALTY MOWING			
12	EA	SP	ESTABLISHMENT			
7	EA	SP	LARGE BOULDER			
6	EA	SP	MEDIUM BOULDER			
8	EA	SP	SMALL BOULDER			
200	CY	1670	MULCH FOR PLANTING			
80	M/G	1670	WATER FOR PLANTING			
1,500	SY	1670	POSTEMERGENCE HERBICIDAL TREATMENT FOR PLANT BEDS			
1,500	SY	1670	PREEMERGENCE HERBICIDAL TREATMENT FOR PLANT BEDS			
1	LS	SP	LANDSCAPE GRADING			
1,440	SY	SP	SODDING			
380	SF	SP	STACK STONE LANDSCAPE EDGING			
620	CY	SP	TOPSOIL			

### GRAPHIC SCALES

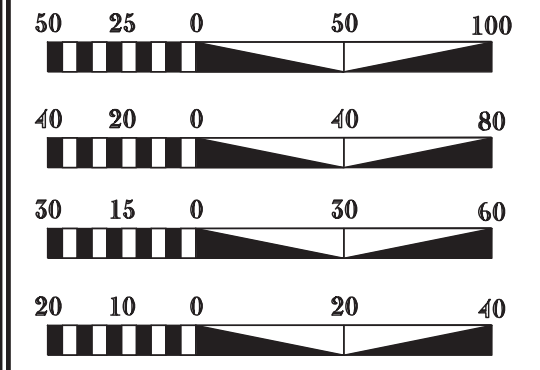

### INDEX OF (L) SHEETS:

- L1A - TITLE SHEET
- L1B - PLANTING DETAILS
- L1C - ROADSIDE DETAILS
- L1D - SHEET LAYOUT PLAN/SYMBOLY
  
- L2A - LANDSCAPE PLANTING PLAN
- L2B - LANDSCAPE GRADING PLAN
- L2C - LANDSCAPE SITE PLAN
- L3 - LANDSCAPE PLANTING PLAN
- L4 - LANDSCAPE PLANTING PLAN

Designed By: Jeff Lackey 10/2022

### REVISIONS

DATE	DESCRIPTION

STATE OF  
**NORTH CAROLINA**  
DEPARTMENT OF TRANSPORTATION

LOCATION: Corridor Enhancements & Aesthetics, BURNSVILLE - North Carolina

TYPE OF WORK: LANDMARK Corridor Enhancement Design & Development

COUNTY: **YANCEY COUNTY**

### 2018 STANDARD SPECIFICATIONS

PREPARED IN THE OFFICE OF:  
NCDOT- ROADSIDE ENVIRONMENTAL UNIT  
DESIGN & DEVELOPMENT SECTION  
1557 MAIL SERVICE CENTER  
RALEIGH NC 27699 919-707-2920

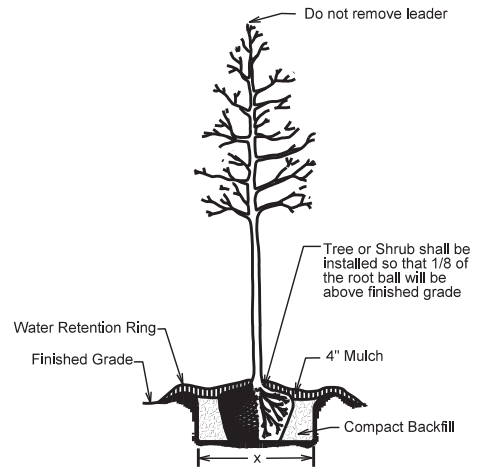

**TREE OR SHRUB PLANTING DETAIL**  
(LEVEL GROUND)

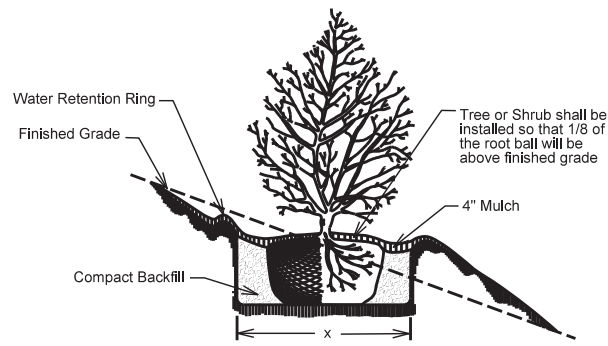

**TREE OR SHRUB PLANTING DETAIL**  
(SLOPING GROUND)

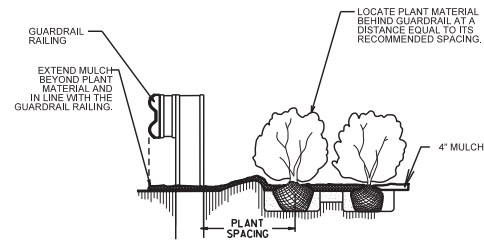

**GUARDRAIL MULCHING DETAIL**  
\* Detail to be used when approved by the Engineer.

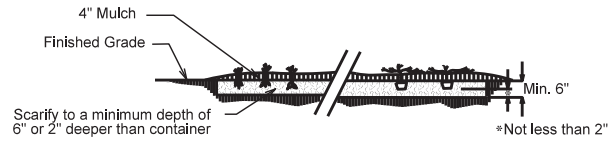

**Groundcover Planting Detail**

Align Grasses around the edge of plant bed to establish GRID. Start center of grasses & perennials half the spacing distance from edge of plant bed

Establish the O.C. Grid for Grasses & Perennials. See Plant List for individual spacing.

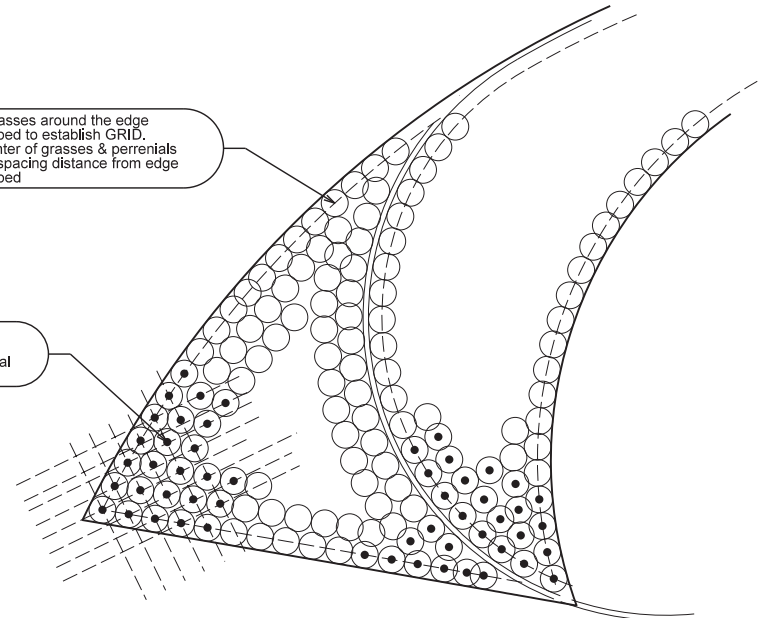

Typical Plan View @ Layout for Native Grass & Perennial Plantings  
No Scale

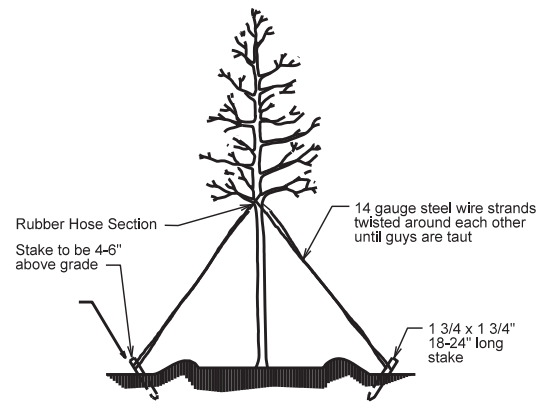

**TREE GUYING DETAIL**  
(FOR TREES 10' OR LARGER)

\* Utilize guying detail only if requested by the Engineer.

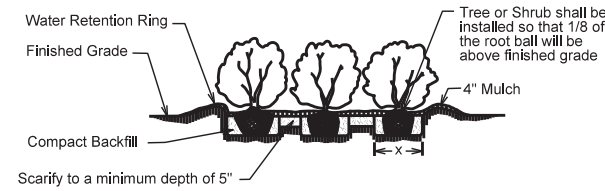

**Shrub Bed Planting Detail**

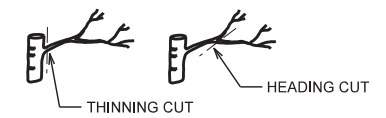

**PRUNING CUTS**

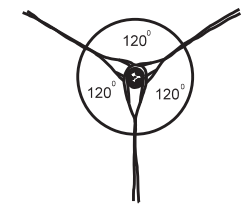

**GUY SPACING DETAIL**

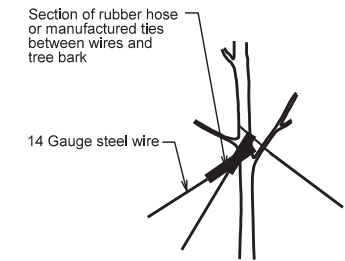

**GUY TYING DETAIL**

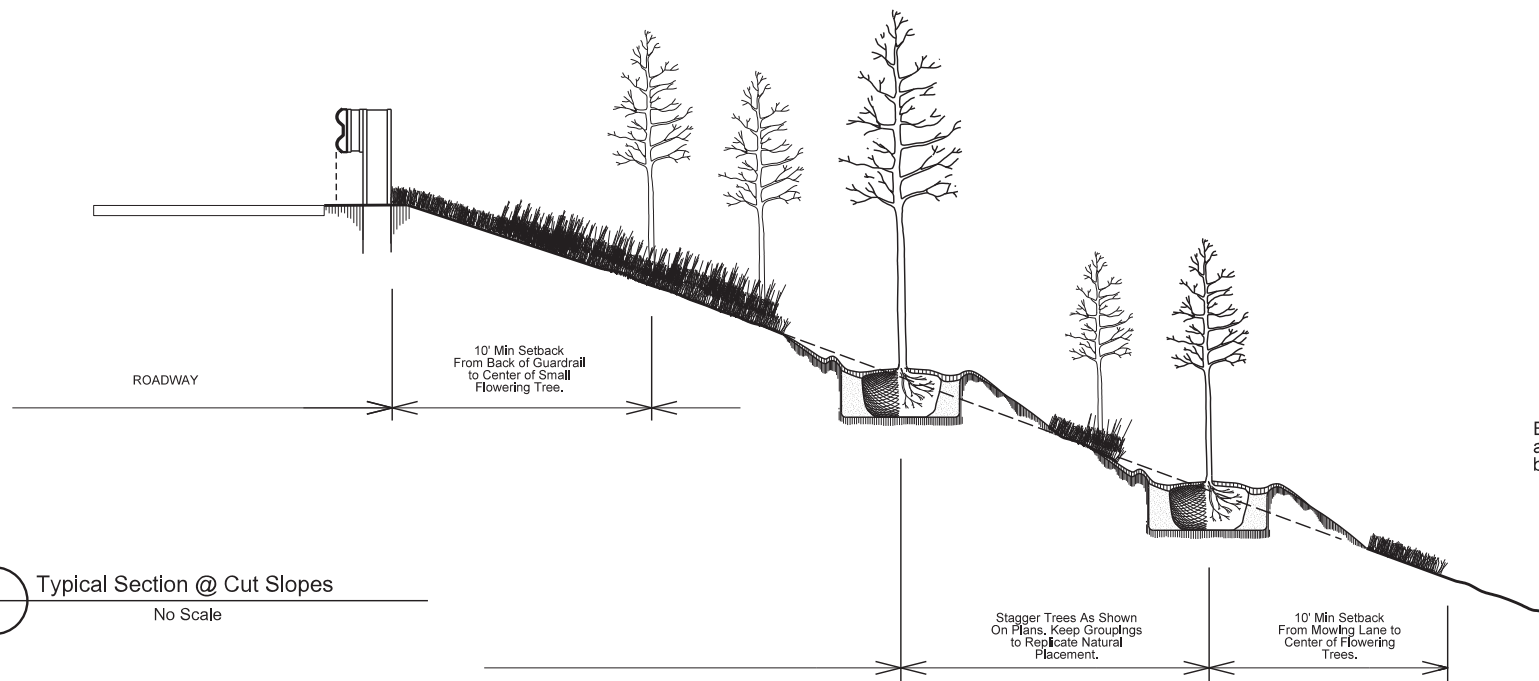

Typical Section @ Cut Slopes  
No Scale

Ensure at a minimum a 1/3 of the boulder is buried.

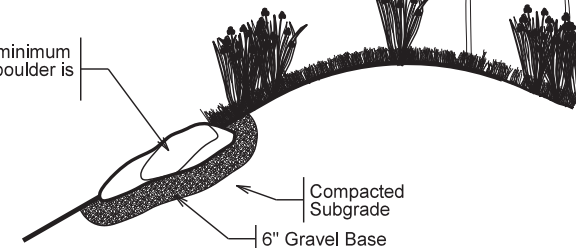

Typical Section @ Boulders  
No Scale

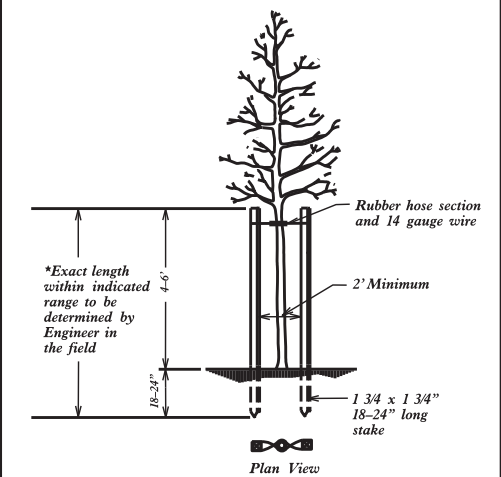

**STAKING DETAIL**  
(FOR TREES 6' TO 10')

\* Utilize staking detail only if requested by the Engineer.





# PLANT SYMBOLOGY

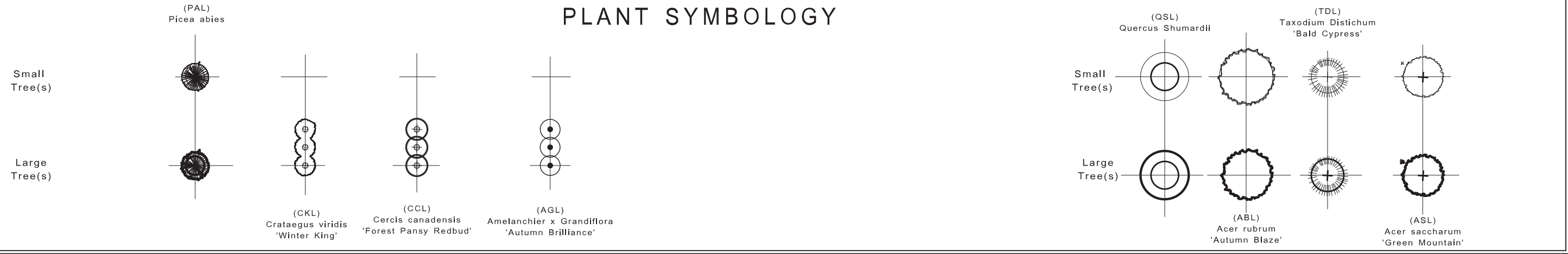

### Notes:

- Contractor Shall Consult with Engineers Prior to any field adjustments. Follow plans as close as possible. Bed layouts should be adjusted to incorporate existing traffic signage, where necessary, and any sight distance issues that may develop -especially at the intersections. Ensure caution is maintained during stakeout to maintain clear site lines. Details may be adjusted to accommodate site. Spacing may be decreased to fit material at specified locations. Consult with Architect to ensure proper development.

-Contractor shall utilize all NCDOT Standard Specifications for all line items listed. These shall be utilized in conjunction with the Special Provisions. Consult with Engineer in the field to maintain accuracy.

-Mowing and seeding and mulching shall take place along all utility strips and most areas along existing ROW-SEE PLANS. Note-the seeding and mulching special provisions outline mowing height and other important information. Those areas where trees are to be incorporated shall be mowed out initially and maintained as directed by the NCDOT Specs. Consult with Architect & Engineer in the field. All Native Grass, Perennials Plantings shall be installed as a continuous mulched bed and shall be treated with Post- Emergence treatment. The individual trees shall be treated with Post Emergence and mulched individually as shown on the plans. Maintain labeled diameter mulch rings.

-Trees to be field staked by the ARCHITECT/ENGINEER. Consult with Engineer for more detailed information to ensure the plants are located according to NCDOT Standard Specifications and are in no conflict with existing utilities and rock formations.

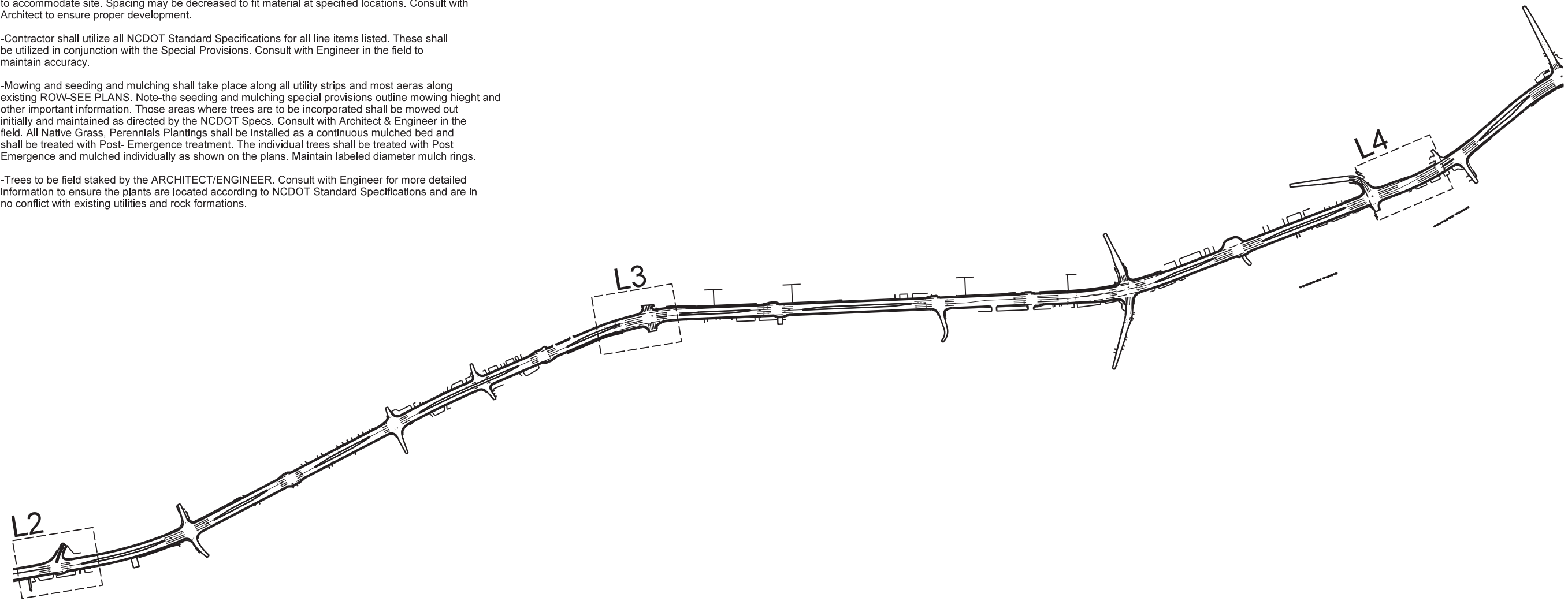

07/09/17

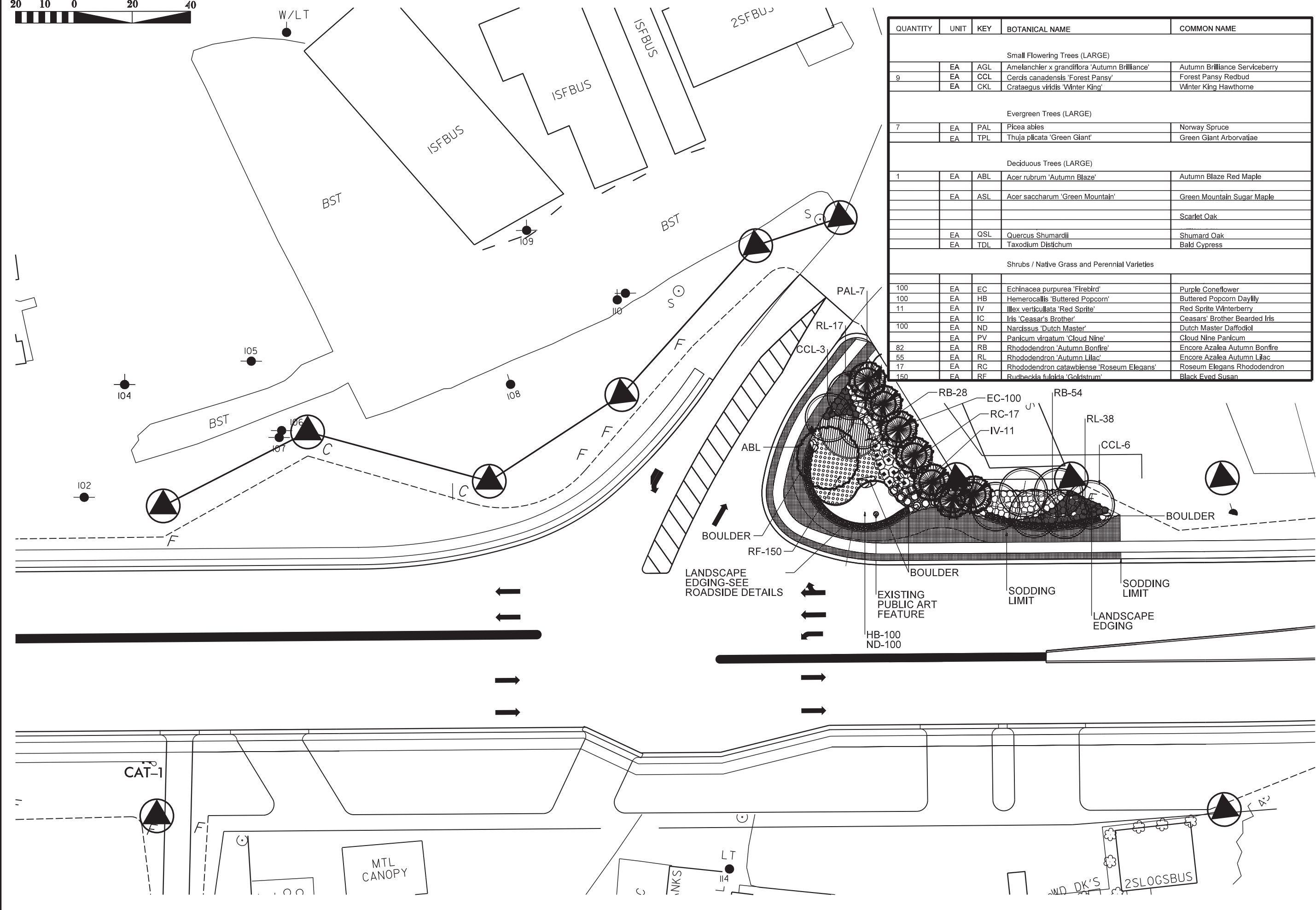

QUANTITY	UNIT	KEY	BOTANICAL NAME	COMMON NAME
Small Flowering Trees (LARGE)				
9	EA	AGL	Amelanchier x grandiflora 'Autumn Brilliance'	Autumn Brilliance Serviceberry
	EA	CCL	Cercis canadensis 'Forest Pansy'	Forest Pansy Redbud
	EA	CKL	Crataegus viridis 'Winter King'	Winter King Hawthorne
Evergreen Trees (LARGE)				
7	EA	PAL	Picea abies	Norway Spruce
	EA	TPL	Thuja plicata 'Green Giant'	Green Giant Arborvitae
Deciduous Trees (LARGE)				
1	EA	ABL	Acer rubrum 'Autumn Blaze'	Autumn Blaze Red Maple
	EA	ASL	Acer saccharum 'Green Mountain'	Green Mountain Sugar Maple
				Scarlet Oak
	EA	QSL	Quercus shumardii	Shumard Oak
	EA	TDL	Taxodium distichum	Bald Cypress
Shrubs / Native Grass and Perennial Varieties				
100	EA	EC	Echinacea purpurea 'Firebird'	Purple Coneflower
100	EA	HB	Hemerocallis 'Buttered Popcorn'	Buttered Popcorn Daylily
11	EA	IV	Ilex verticillata 'Red Sprite'	Red Sprite Winterberry
	EA	IC	Iris 'Ceasar's Brother'	Ceasar's Brother Bearded Iris
100	EA	ND	Narcissus 'Dutch Master'	Dutch Master Daffodil
	EA	PV	Panicum virgatum 'Cloud Nine'	Cloud Nine Panicum
82	EA	RB	Rhododendron 'Autumn Bonfire'	Encore Azalea Autumn Bonfire
55	EA	RL	Rhododendron 'Autumn Lilac'	Encore Azalea Autumn Lilac
17	EA	RC	Rhododendron catawbiense 'Roseum Elegans'	Roseum Elegans Rhododendron
150	EA	RF	Rudbeckia fulgida 'Goldstrum'	Black Eyed Susan

SHEET NO.  
L2A

PROJECT REF. NO.  
R-2519A(L) - US 19

US 19 Corridor Enhancements & Aesthetics  
Burnsville, North Carolina



N.C. Department of Transportation  
Roadside Environmental Unit - Aesthetic Engineering Section  
Planning Plan

L2A

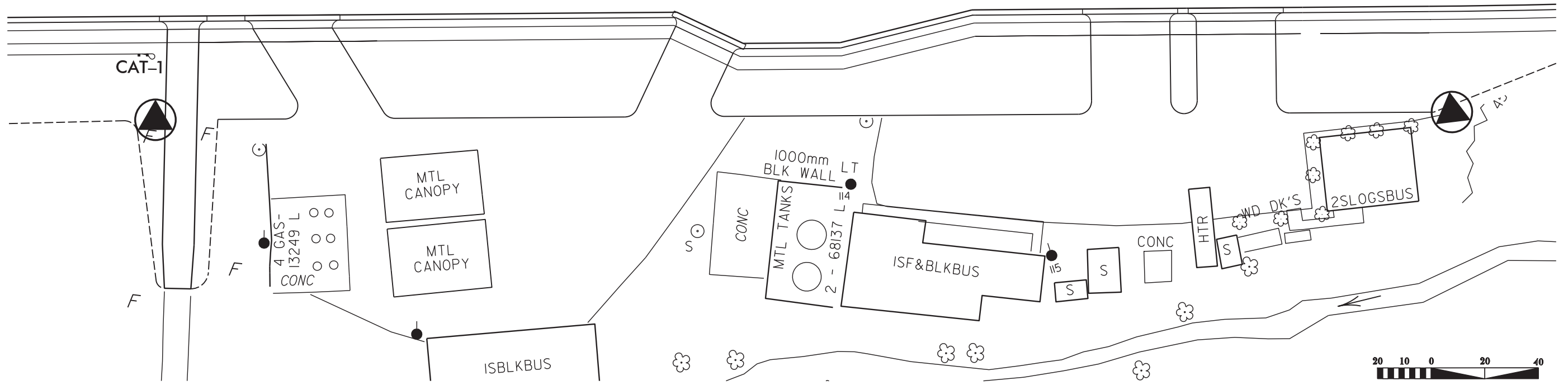
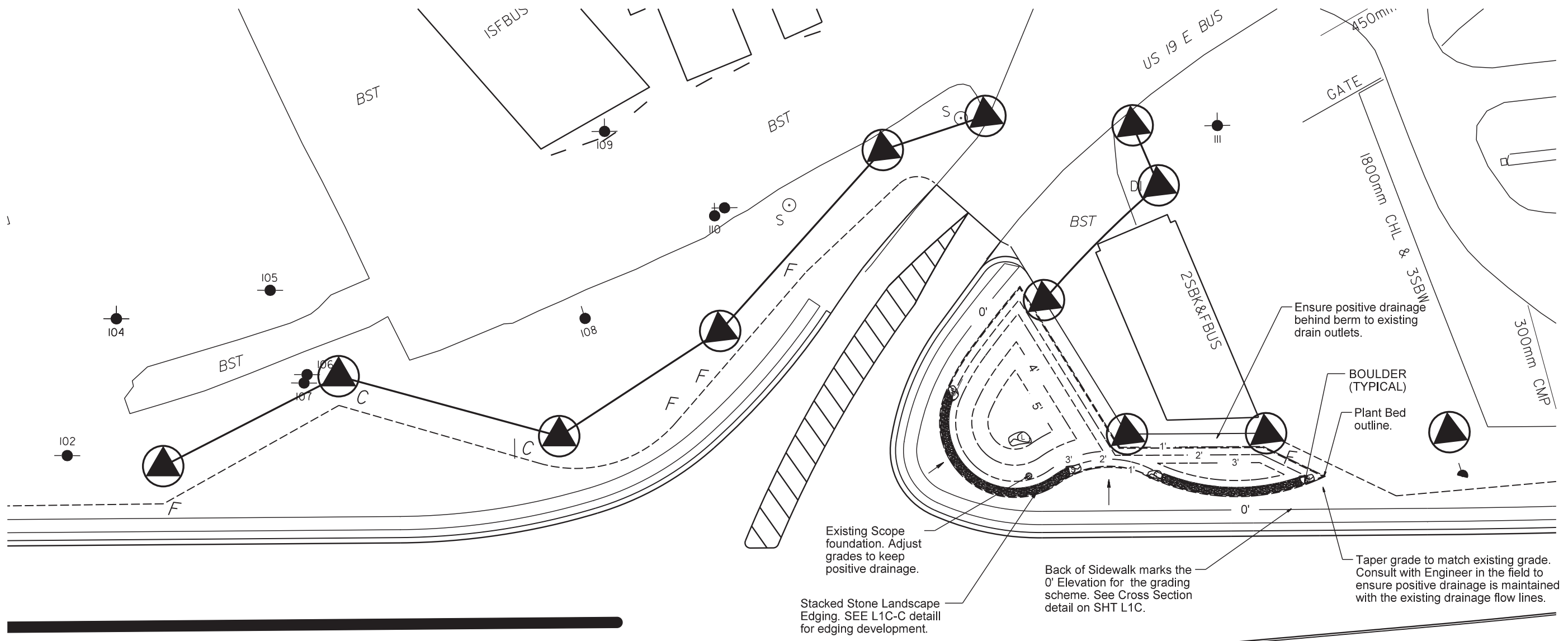





07/09/17

QUANTITY	UNIT	KEY	BOTANICAL NAME	COMMON NAME
Small Flowering Trees (LARGE)				
9	EA	AGL	Amelanchier x grandiflora 'Autumn Brilliance'	Autumn Brilliance Serviceberry
31	EA	CCL	Cercis canadensis 'Forest Pansy'	Forest Pansy Redbud
9	EA	CKL	Crataegus viridis 'Winter King'	Winter King Hawthorne
Evergreen Trees (LARGE)				
	EA	PAL	Picea abies	Norway Spruce
	EA	TPL	Thuja plicata 'Green Giant'	Green Giant Arborvitae
Deciduous Trees (LARGE)				
	EA	ABL	Acer rubrum 'Autumn Blaze'	Autumn Blaze Red Maple
	EA	ASL	Acer saccharum 'Green Mountain'	Green Mountain Sugar Maple
	EA	QSL	Quercus shumardii	Shumard Oak
	EA	TDL	Taxodium distichum	Bald Cypress
Shrubs / Native Grass and Perennial Varieties				
	EA	EC	Echinacea purpurea 'Firebird'	Purple Coneflower
	EA	HB	Hemerocallis 'Buttered Popcorn'	Buttered Popcorn Daylily
	EA	IV	Illex verticillata 'Red Sprite'	Red Sprite Winterberry
1330	EA	IC	Iris 'Ceasar's Brother'	Ceasars' Brother Bearded Iris
1330	EA	ND	Narcissus 'Dutch Master'	Dutch Master Daffodil
	EA	PV	Panicum virgatum 'Cloud Nine'	Cloud Nine Panicum
	EA	RB	Rhododendron 'Autumn Bonfire'	Encore Azalea Autumn Bonfire
	EA	RL	Rhododendron 'Autumn Lilac'	Encore Azalea Autumn Lilac
	EA	RC	Rhododendron catawbiense 'Roseum Elegans'	Roseum Elegans Rhododendron
	EA	RF	Rudbeckia fulgida 'Goldstrum'	Black Eyed Susan

